

CPTED PRINCIPLES

- CPTED PRINCIPLE #1 NATURAL SURVEILLANCE**
 - There are windows in the business office facility on all four sides. Employees can observe deliveries and visitors entering from the street into the parking lot from the existing windows and doors of the business building and offices.
 - The newly renovated and retrofitted lighting plan is providing excellent illumination to the exterior of the buildings, the stock areas, the exterior yard area, and vehicular entrances for good visibility and accountability.
- CPTED PRINCIPLE #2 NATURAL ACCESS CONTROL**
 - Accomplished by having chain link fence and aluminum fences on the North, South and East boundaries. West boundary will have a decorative fencing a vehicular gates to create open visibility for employees, staff and video surveillance.
 - There will be video surveillance at the vehicle entrances, the truck loading areas, the dumpster area, and parking lots.
 - Motion activated sensors and infrared cameras may be used on the perimeter boundaries and the storage areas to detect movement and record ant activity in what should otherwise quiet, except Oldcastle workers.

*Note: Video surveillance system should be a fixed lens and not pan tilt and zoom, weather proof and vandal resistant. Cameras should be with night vision capability because they are being used 24/7.

- CPTED PRINCIPLE #3 TERRITORIAL REINFORCEMENT**
 - Ground planting and hedges should be less than 3 feet and tree canopies over 8 feet to allow clear zone of natural surveillance for police to be able to have un-obscured sight around the perimeter and into the property.
- CPTED PRINCIPLE #4 MAINTENANCE**
 - Tree canopies should be maintained clear under 8 feet, with a tree trunk six inches in diameter or greater.
 - The west border will be improved with an attractive picket metal code complaint fencing with plantings and vehicle gate. It is recommended that as the site is improved to accommodate a sidewalk connection, and new monumental sign, and additional stripping at the entrance of onto Andrews Avenue will be added to direct the heavy trucks and rigs.
- CPTED PRINCIPLE #5 ACTIVITY SUPPORT**

This facility is currently operating 24 hours a day except Saturdays and Sundays. The site is also on a heavily traveled Andrews Avenue Extension. This means there are less hours of the site being unattended. Andrews Ave. Extension

- The Oldcastle Bonsal site plan expansion has planned to improve the security functions focused on the site, and in the weighing and drop off and loading areas.
- Groundrules will be supplemental to spell out clearly the rules of unauthorized access and trespass, and where and when the trucks drivers should go.
- The activity support from having a number of employees working on the site around the clock is the strongest deterrent to crime on and around the property.
- The employees serve as capable guardians of the property and can challenge trespassers and call police for quick response.

GENERAL DEFENSIBLE SPACE NOTES:

- The new site plan is proposing a vehicular and pedestrian access control gates, warning and groundrule signage, site video surveillance, improved site lighting, a new and improved monumental sign and replacing any missed fence to close fence gaps which will improve safety security to the Old Coastal facility and operations.
- * Note: For additional information, see Atlas Safety and Security Design Inc, Security report.

GENERAL PROPERTY NOTES:

18"x24" BROWARD COUNTY NO TRESPASSING SIGNS TO BE USED

SECURITY CAMERAS RECOMMENDED TO FULLY VIEW ALL NEW PARKING LOT AREAS AND BUILDING ENTRANCES

| CRIME PREVENTION & CPTED PUBLIC SAFETY/SECURITY DRAWING LEGEND | |
|--|--|
| All exterior doors to be on alarm system | FA |
| SN: Surveillance Natural | SE |
| SE: Surveillance Electronic (Fixed lens camera) | ACN: Access Control - Natural |
| ACN: Access Control - Natural | ACP: Access Control - Physical (Built) |
| ACP: Access Control - Physical (Built) | TR: Territorial Reinforcement |
| TR: Territorial Reinforcement | M: Maintenance |
| M: Maintenance | AS: Activity Support |
| AS: Activity Support | |
| NOTE: CPTED & Crime Prevention SECURITY concepts complement each other and overlap. Example: SN can overlap with TR & AS, etc. | |

ALSO SEE SECURITY REPORT BY:

ATLAS SAFETY & SECURITY DESIGN, INC.
333 LAS OLAS WAY SUITE 1605 FORT LAUDERDALE, FLORIDA 33301 PHONE 305-332-6588
EMAIL: RATLAS@IX.NETCOM.COM

BONSAL SITE IMPROVEMENTS

1200 NW 18TH ST
POMPAÑO BEACH FL 33069

| REVISIONS | | |
|-----------|--------------|----------|
| No. | Description | Date |
| 1 | DRC RESUBMIT | 8-12-24 |
| 2 | DRC RESUBMIT | 10-09-24 |
| 3 | DRC RESUBMIT | 12-18-25 |
| | | |
| | | |
| | | |
| | | |
| | | |
| | | |
| | | |
| | | |

PROJECT STATUS
MINOR SITE PLAN SBMT
DATE
OCTOBER 9, 2024
PROJECT NUMBER
2123
SCALE
AS SHOWN
DRAWN BY
O.H.
CHECKED BY
J.T.
DRAWING TITLE

CPTED PLAN
DRAWING NUMBER
SP-201

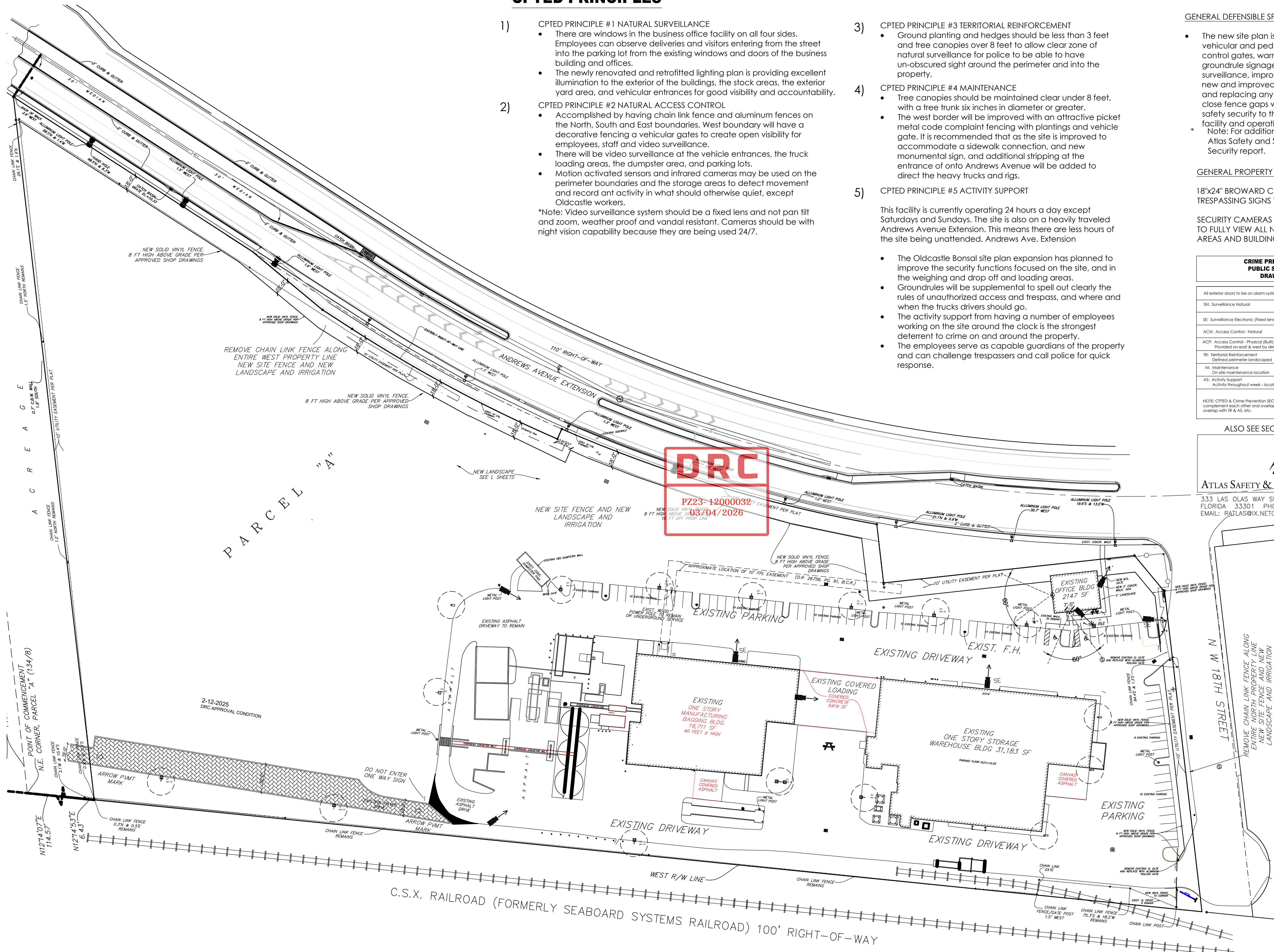

1

CPTED PLAN

1" = 50'-0"

0 25 50 100

CRIME PREVENTION THROUGH ENVIRONMENTAL DESIGN

NORTH



AA26001731
SEAL

BRIAN P. HERBERT FL AR0015474
PROJECT

OWNER